

**LINE 115: HELENDALE - FORT IRWIN
AM**

NORTHBOUND

From Vista Rd

- | | | | |
|-----|------------------------------------|-----|--------------------------------------|
| (L) | National Trails Hwy | (R) | into Child Development Center |
| (R) | L St | | Loop counterclockwise in parking lot |
| (L) | into Park & Ride | (L) | Barstow Rd |
| | circle left inside of Park & Ride | (L) | North Loop Rd |
| | perimeter | (L) | South Loop Rd |
| (L) | L St | (R) | Langford Lake Rd |
| (L) | 15 Freeway North | (R) | Mates |
| (R) | 40 Freeway East | (L) | South Depot Loop |
| (R) | Montara Rd exit | | into Inner Loop Rd |
| (R) | Montara Rd | (L) | 5th St |
| (R) | into Montara Elementary School lot | (R) | Outer Loop Rd |
| | circle through lot | (R) | Barstow Rd |
| (L) | Montara Rd | (L) | 5th St |
| | Continue onto Main St | (R) | South Loop Rd |
| (L) | 40 Freeway | (R) | 3rd St |
| | into 15 Freeway | (L) | G Ave |
| (R) | Barstow Rd exit | (L) | 2nd St |
| (R) | Barstow Rd | (L) | into 1st driveway of bus lot |
| (L) | Williams | | |
| | to stop by parking lot | | |
| (R) | 2nd Ave | | |
| (L) | Main St | | |
| (R) | 1st Ave | | |
| (L) | Irwin Rd | | |
| (R) | Irwin Rd | | |
| | stop at Mt View Cemetery | | |
| | continue on Irwin Rd | | |
| (L) | Fort Irwin Rd | | |
| | stop at Mt View Cemetery | | |
| | continue on Irwin Rd | | |
| (L) | Fort Irwin Rd | | |
| (R) | Ammo Route | | |
| | Ammo Route will parallel | | |
| | Fort Irwin Rd, and will go back | | |
| | into Fort Irwin Rd | | |
| | stay to left side for buses as | | |
| | entering Fort Irwin | | |
| | continue into South Loop Rd | | |
| (L) | North Loop Rd | | |
| (R) | Barstow Rd | | |

**LINE 115: HELENDALE - FORT IRWIN
PM**

SOUHBOUND

From Fort Irwin Bus Lot

- | | | | |
|-----|--------------------------------------|-----|-----------------------------------|
| (L) | 2nd St | (R) | L St exit |
| (R) | South Loop Rd | (R) | L St |
| (L) | Langford Lake Rd | (R) | into Park & Ride |
| (R) | Mates | | right to bus loading zone next |
| (L) | South Depot Loop | | to sidewalk by L St |
| | into Inner Loop Rd | | circle left inside of Park & Ride |
| (L) | 5th St | | perimeter |
| (R) | Outer Loop Rd | (R) | L St |
| (R) | Barstow Rd | (L) | National Trails Hwy |
| (L) | 5th St | (R) | Vista Rd |
| (R) | South Loop Rd | (L) | Helendale Rd |
| (R) | North Loop Rd | (R) | Chaparral |
| (R) | Barstow Rd | (R) | Strawberry |
| (R) | into Child Development Center | (R) | Vista Rd |
| | Loop counterclockwise in parking lot | | to bus stop NS Helendale Rd |
| (L) | Barstow Rd | | |
| (L) | North Loop Rd | | |
| (R) | South Loop Rd | | |
| (R) | into Irwin Rd | | |
| | stop across from Mt View Cemetery | | |
| | continue on Irwin Rd | | |
| (R) | 1st Ave | | |
| (L) | Main St | | |
| (R) | Barstow Rd | | |
| (R) | Williams | | |
| | to stop by parking lot | | |
| (L) | 2nd Ave | | |
| (L) | Buena Vista St | | |
| (R) | Barstow Rd | | |
| (L) | 15 Freeway North | | |
| (R) | 40 Freeway | | |
| (R) | Montara Rd exit | | |
| (R) | Montara Rd | | |
| (R) | into Montara Elementary School lot | | |
| | circle through lot | | |
| (L) | Montara Rd | | |
| | to Walmart bus stop | | |
| (L) | 40 Freeway | | |
| | Into 15 Freeway South | | |

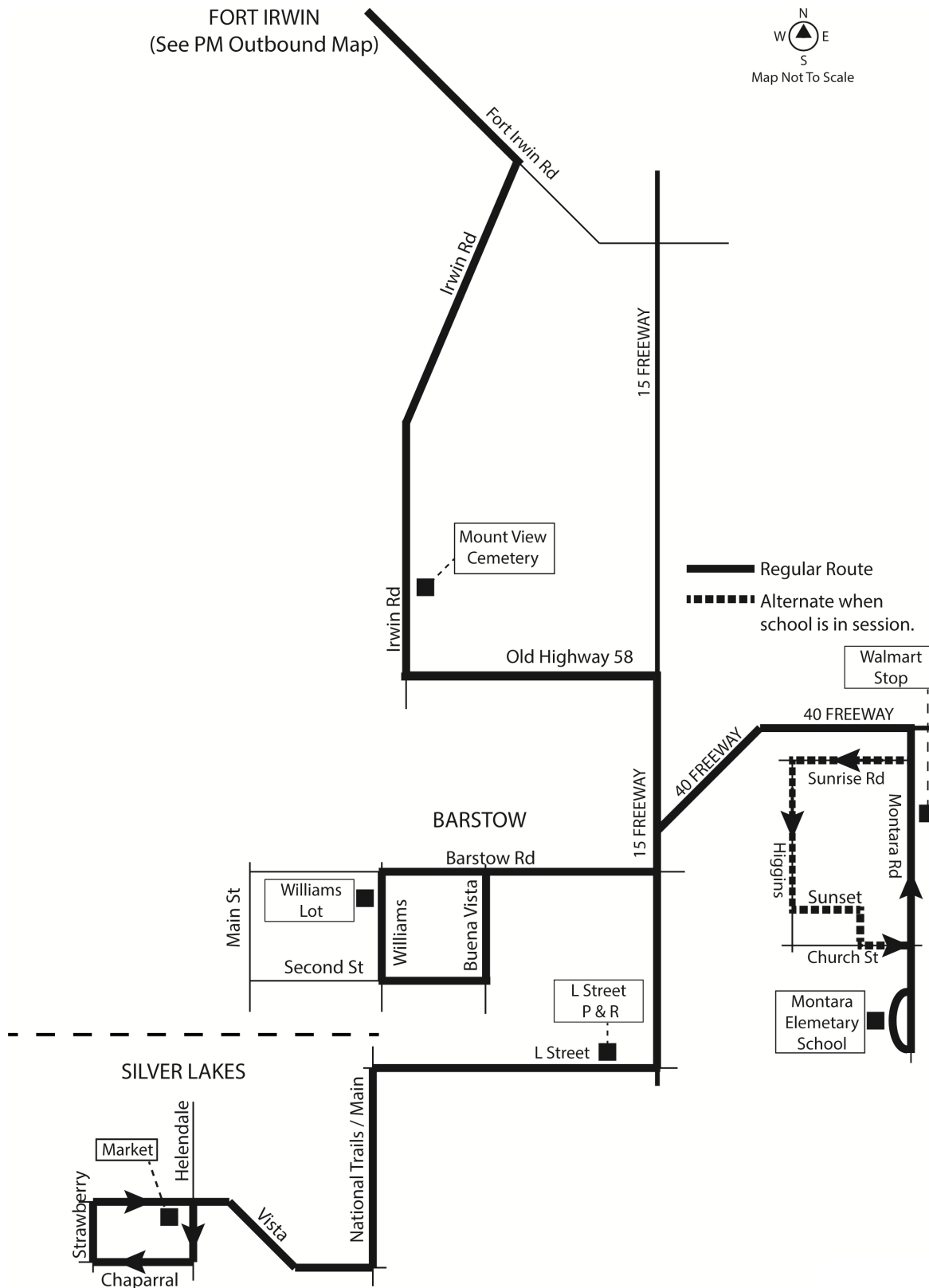

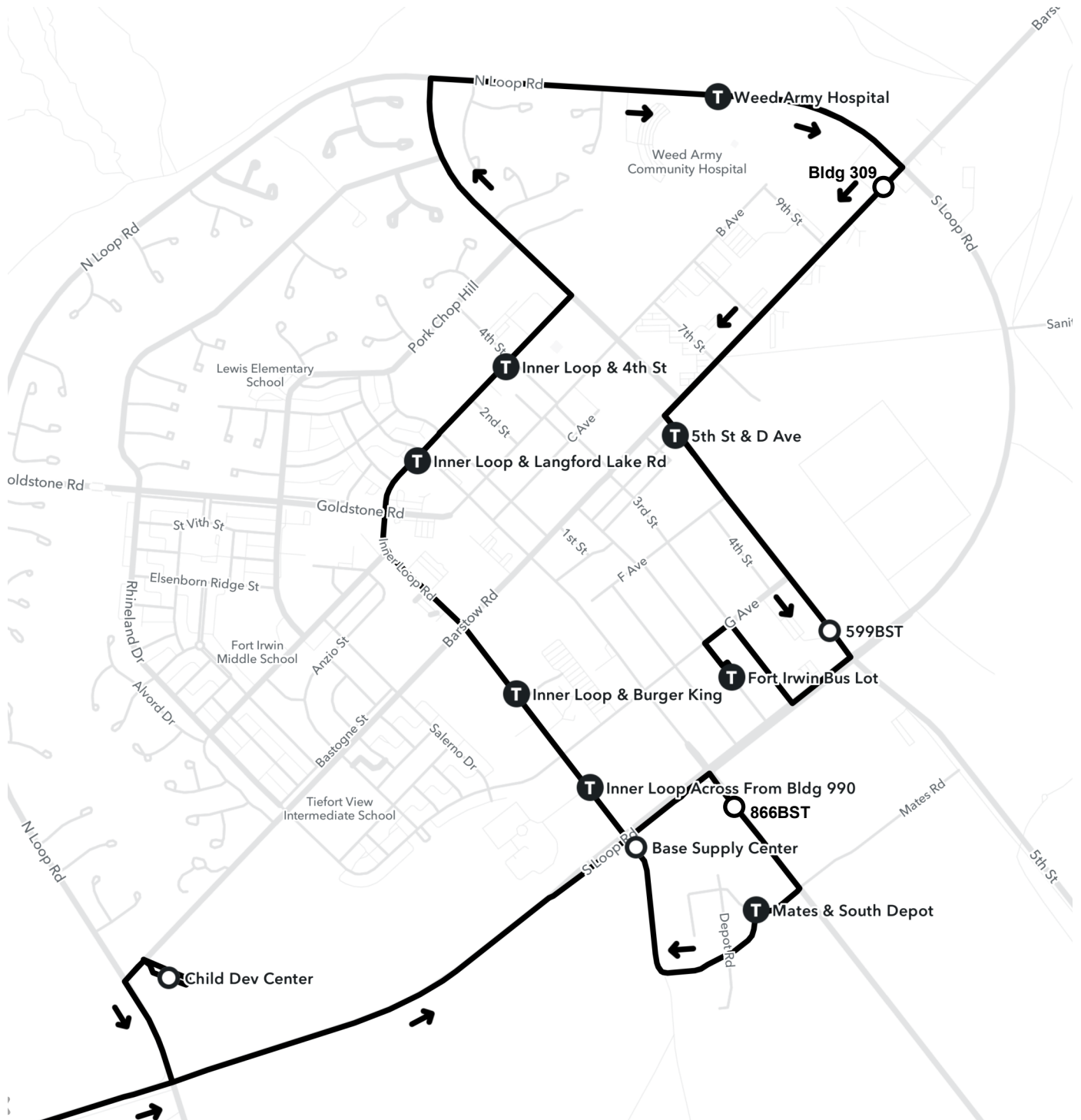

LINE 115: HELENDALE - FORT IRWIN
PM

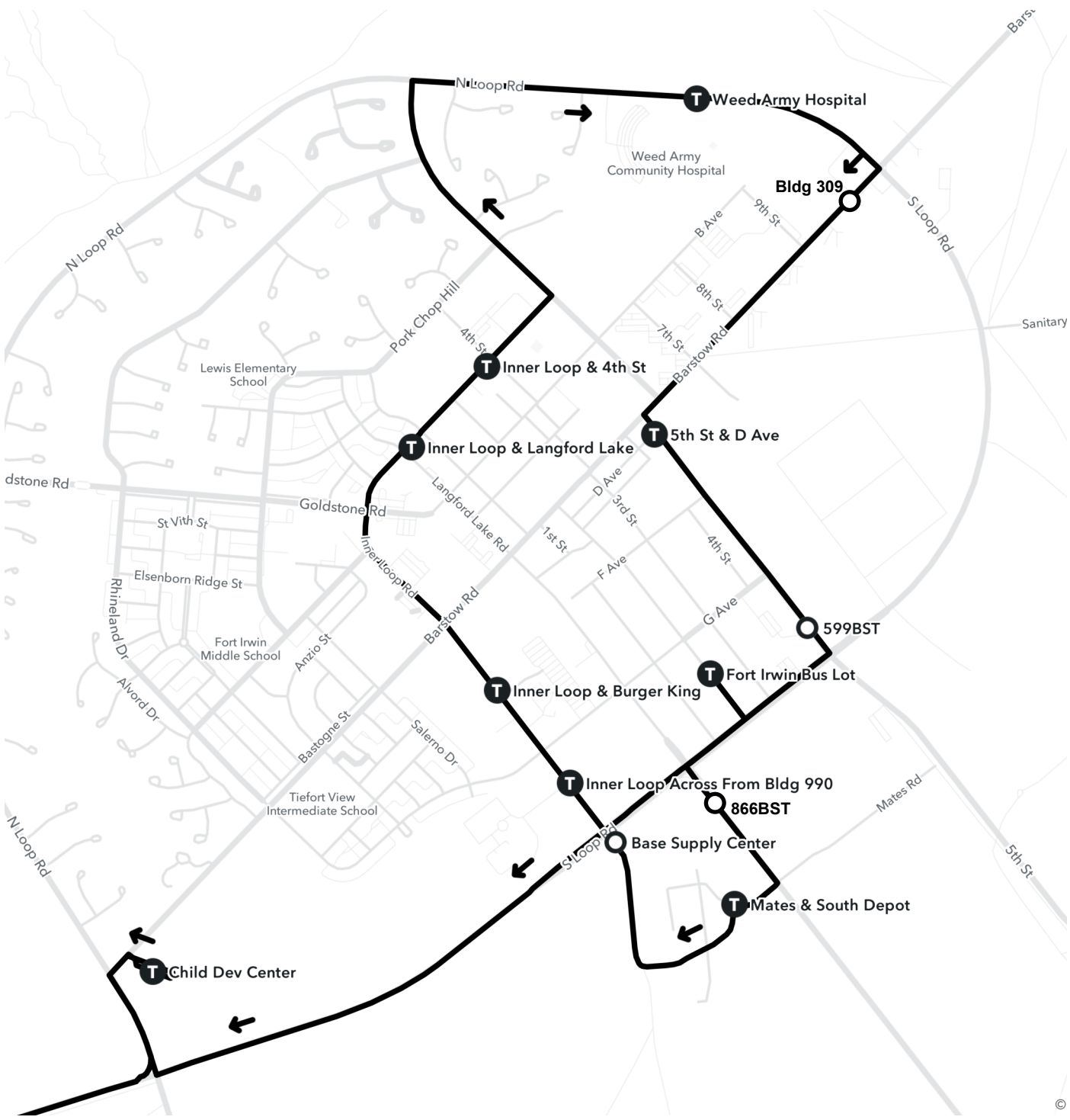

LINE 115: HELENDALE - FORT IRWIN

PULL IN/PULL OUT ROUTES

TO VISTA RD & HELENDALE RD FROM HESPERIA DIVISION:

From Hesperia Division, (R) Smoke Tree St, (L) E Ave, (R) Main St, (R) 7th Ave into Arrowhead Rd, (L) Green Tree Blvd, (R) 7th St, (L) D St into National Trails Hwy, (L) Vista Rd, (L) Helendale Rd, (R) Chaparral, (R) Strawberry, (R) Vista Rd to bus stop NS Helendale Rd.

FROM VISTA RD & HELENDALE RD TO BARSTOW DIVISION:

via Vista Rd, (L) National Trails Hwy into W Main St, (L) Sandstone Ct, (L) into Barstow Division.

FROM VISTA RD & HELENDALE RD TO HESPERIA DIVISION:

via Vista Rd, (R) National Trails Hwy into D St, (R) 7th St, (L) Green Tree Blvd, (R) 3rd Ave, (R) Main St, (L) E Ave, (R) Smoke Tree St, (L) into Hesperia Division.

TO FORT IRWIN BUS LOT FROM BARSTOW DIVISION:

From Barstow Division, (R) Sandstone Ct, (R) W Main St, (L) 58 Freeway East, (R) 15 Freeway North, (R) Fort Irwin Rd exit, (L) Fort Irwin Rd, (R) Ammo Route (Ammo Route will parallel Fort Irwin Rd, and will go back into Fort Irwin Rd), stay to left side for buses as entering Fort Irwin, continue into South Loop Rd, (L) Inner Loop, (R) G Ave, (R) Second St, (L) into 1st driveway of bus lot.

TO FORT IRWIN BUS LOT FROM HESPERIA DIVISION:

Hesperia Yard via Smoke Tree, (L) E Ave, (R) Main St, (R) 3rd Ave, (R) Yucca St, (L) Hesperia Rd, (R) D St, (L) Stoddard Wells Rd, (L) 15 Freeway North, (R) Fort Irwin Rd exit, (L) Fort Irwin Rd, (R) Ammo Route (Ammo Route will parallel Fort Irwin Rd, and will go back into Fort Irwin Rd), stay to left side for buses as entering Fort Irwin, continue into South Loop Rd, (L) Inner Loop, (R) G Ave, (R) Second St, (L) into 1st driveway of bus lot.

FROM FORT IRWIN BUS LOT TO HESPERIA DIVISION:

(L) Second St, (R) South Loop Rd, into Fort Irwin Rd, (R) 15 Freeway South, (R) D St/Hwy 18 exit, (R) D St/Hwy 18, (R) 7th St, (L) Forrest Ave, (R) Hesperia Rd, (R) Walnut St, (R) 3rd Ave, (R) Main St, (L) E Ave, (R) Smoke Tree St, (L) into Hesperia Division.

DESTINATION SIGN CODES:

TERMINAL	DISPLAY	CODE
Fort Irwin Bus Lot	115 Fort Irwin	1151
Helendale	115 Helendale	1152
	Sorry, Not In Service	101